

A

B

C

D

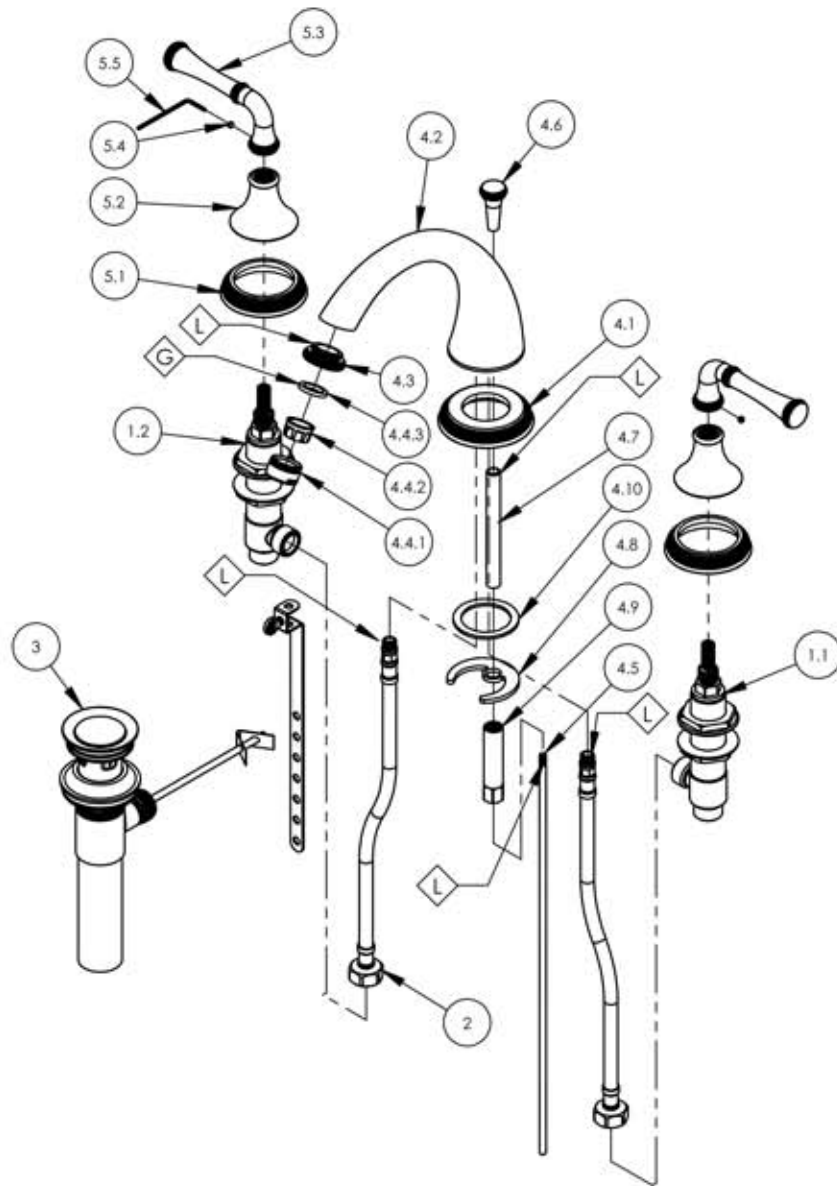

ITEM NO.	PART NUMBER	DESCRIPTION	QTY.
1	1-600	WIDESPREAD HOT AND COLD VALVES W/PLASTIC NUTS	1
1.1	1-109	WIDESPREAD VALVE COLD LAV 16PT	1
1.2	1-110	WIDESPREAD VALVE HOT LAV 16PT	1
2	10720	HOSE, M10 TO 1/2NPSM1"	2
3	3-046/00	POP-UP DRAIN ASSEMBLY (2-101, 2-102)	1
4	3-316/00	WIDESPREAD SPOUT, COINED SERIES	1
4.1	10979/00	ESCUTCHEON FOR WIDESPREAD SPOUT BASE, COINED, 3RING	1
4.2	P03024NL/00	SPOUT, SMOOTH	1
4.3	10981/00	AERATOR HOUSING, COINED SERIES	1
4.4	3-059/00	AERATOR, 15/16" MALE HOUSING	1
4.4.1	30032/00	AERATOR HOUSING 15/16" MALE HOUSING	1
4.4.2	30031	AERATOR DROP-IN INSERT 1.5 GPM	1
4.4.3	30030	RUBBER SEAL WASHER AERATOR	1
4.5	10719/00	POP-UP ROD, 10-24, 14" LONG	1
4.6	10980/00	POP-UP KNOB, COINED SERIES	1
4.7	10182	NIPPLE, SHANK 1/8"-27NPSM X 4"L	1
4.8	P34002	C-WASHER FOR TEE LESS SPOUT	1
4.9	P34004	2" EXTENSION NUT F/TEE LEES SPOUT	1
4.10	P34005	GASKET FOT TEE LESS.	1
5	3-317/00	LEVER HANDLE, COINED SERIES	2
5.1	10978/00	ESCUTCHEON HANDLE BASE COINED, 3RING, COINED SERIES	1
5.2	10972/00	HUB, TRANSITIONAL 3RING	1
5.3	10977/00	HANDLE, STRAIGHT LEVER COINED, 3RING	1
5.4	92163	SET SCREW, CONE PT 8-32 X 1/8"L	1
5.5	P39001	HEX KEY 5/64, FOR 8-32 SET SCREW	1

## NOTE(S):

1. ALL DIMENSIONS SHOWN ARE FOR REFERENCE ONLY

2. APPLY NSF COMPLAINT GREASE TO ANY O-RING AND/OR SEALING JOINTS. 

3. APPLY NSF COMPLAINT LOCTITE TO THREADED AREA. 

ALL	A	UPDATED FOR BETTER CLARITY	3/26/2014	MAF
-----	---	----------------------------	-----------	-----

ZONE	REV.	DESCRIPTION	DATE	APPROVED
------	------	-------------	------	----------

## REVISIONS

1261 LOGAN AVENUE COSTA MESA, CALIFORNIA 92626 PHONE: 714.361.4800 FAX: 714.617.3120		<b>PHYLIRICH</b> <sup>®</sup> Defining Luxury Since 1959	<b>PROPRIETARY AND CONFIDENTIAL</b> THE INFORMATION CONTAINED IN THIS DRAWING IS THE SOLE PROPERTY OF RSS MANUFACTURING. ANY REPRODUCTION IN PART OR AS A WHOLE WITHOUT THE WRITTEN PERMISSION OF RSS MANUFACTURING IS PROHIBITED.
---	--	---	---

INTERPRET GEOMETRIC DIMENSIONING & TOLERANCING IN ACCORDANCE WITH ASME Y14.5-2009 & ASME Y14.41-2003 STANDARDS, UNLESS OTHERWISE SPECIFIED. DIMENSIONS ARE IN INCHES. TOLERANCES ARE:	
FRACTIONS ±1/64"	DECIMALS X.X: ±.1 X.XX: ±.01 X.XXX: ±.005
ANGULAR ±5°	
NEXT ASSY	USED ON
APPLICATION	
MATERIAL	
FINISH	
DRAWN	LL0 9/22/2015
CHECKED	GRE

## WIDESPREAD FAUCET, LEVER HANDLE, COINED SERIES

SIZE	ASM/PRT NO.	REV
<b>A</b>	208-01/00	-
SCALE: 1:5.5	WEIGHT: lbs.	SHEET 1 OF 2

5

4

3

2

1